

WORKBENCH ASSEMBLY INSTRUCTIONS

DT-XXX-Z Configuration

TOOLS REQUIRED FOR ASSEMBLY

Cordless drill with #2 phillips head bit & 18" magnetic extension,
3/8" and 5/16" magnetic socket bit.

BEFORE ASSEMBLING THE WORKBENCH

Read through the assembly instructions to familiarize yourself with the order in which the parts are assembled. We suggest that you clear & vacuum the area where the bench is to be assembled. It is important that the bench is assembled in the same sequence as instructed.

HARDWARE & GMI COMPONENTS

All assembly hardware is provided. Full size photos accompany each step where hardware is needed.

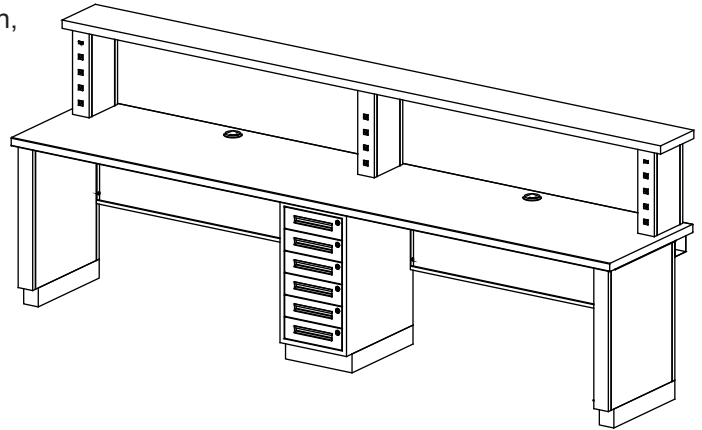

STEP 1

Assemble the modesty panels to the base cabinets. Use four 1/4-20 x 1/2" Bolts with the 3/8" magnetic socket for each modesty panel.

****Your base cabinets may be different than those shown. Follow the same instructions****



1/4-20 x 1/2"
Flange Head Bolt

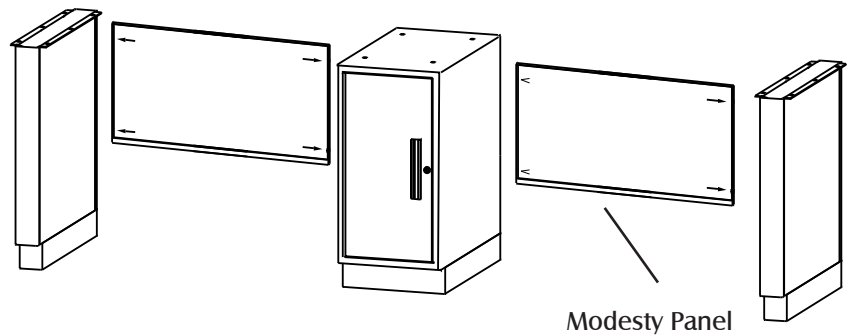

STEP 2

Hook the (Optional) wire management tray over the top lip of the modesty panel.

For (3) base configuration benches the assembly process is the same as shown. The wire tray flange will clip over the modesty panel flange along the top edge.

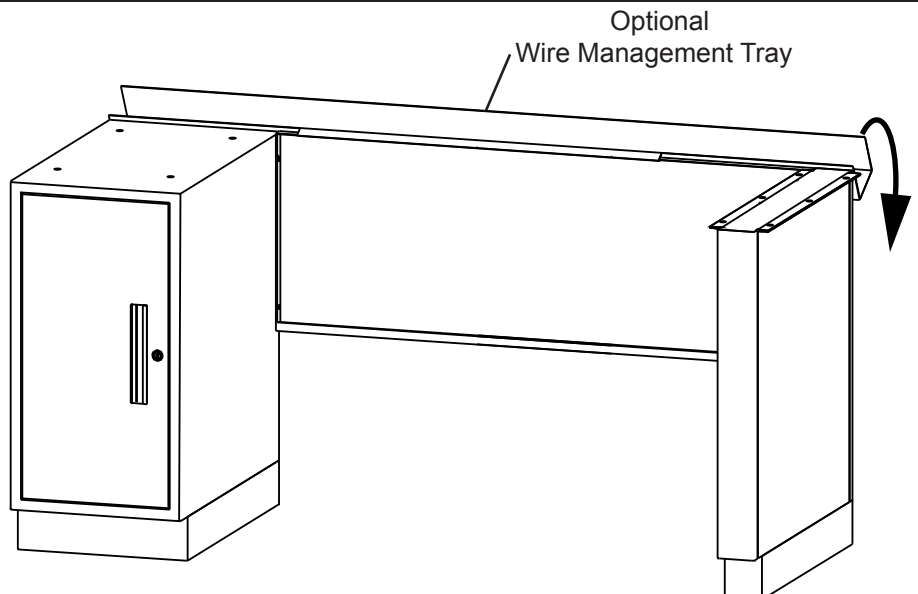

STEP 4

Place the work station in the desired location and level.

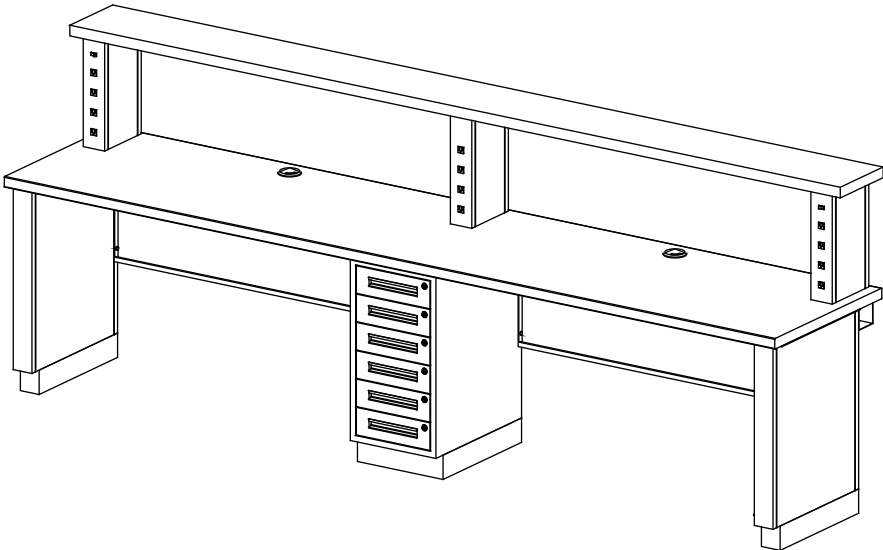

Riser STEP 2

Set the shelf on the risers. Adjust the shelf so there is an even distance left-to-right. Use a straight edge to line up the back of the shelf with the back of the worksurface.

Attach the shelf to each riser using four #14 x 1" Lag Screws with the 3/8" magnetic socket.

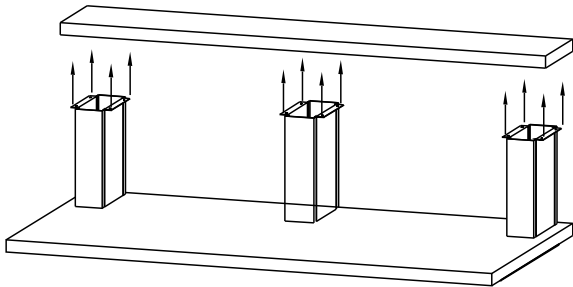

Riser STEP 1

Position the risers on the top so there is 1" from the back of the riser to the back of the worksurface AND 1-1/4" from the side of the riser to the side of the worksurface. If assembling a three riser shelf, position the center riser in the center of the top.

Attach the risers to the top. Use #14 x 1" Lag bolts. (You will need the 18" extension and 3/8" magnetic socket to reach the mounting holes inside).

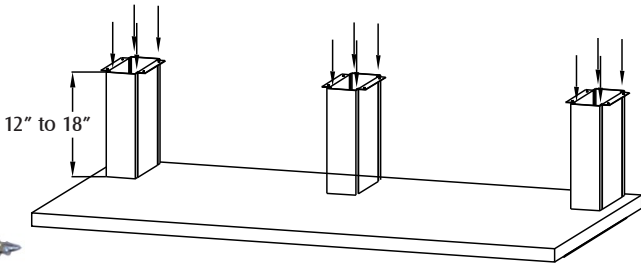

STEP 3

Set the top on the assembled base. Adjust the top to leave no more than a two inch overhang in the front and even gaps on the left and right side.

The 14 x 1 drive screws do not require pre-drilled holes.

Attach the top to each leg pedestal with six #14 x 1" Lag bolts. Use the 3/8" magnetic socket. Next attach the cabinet to the top using four #14 x 1" Lag bolts. Drawer cabinets will require removal of the drawer to access the mounting holes in the top of the cabinet.

