

TOOLS REQUIRED FOR ASSEMBLY

Socket set, Open end wrench set, Cordless drill with 3/8" socket bit (Magnetic recommended).

BEFORE ASSEMBLY

Read through the assembly instructions to familiarize yourself with the order in which the parts are assembled. We suggest that you clear & vacuum the area where the bench is to be assembled. It is important that the bench is assembled in the same sequence as instructed.

HARDWARE

All assembly hardware is provided.

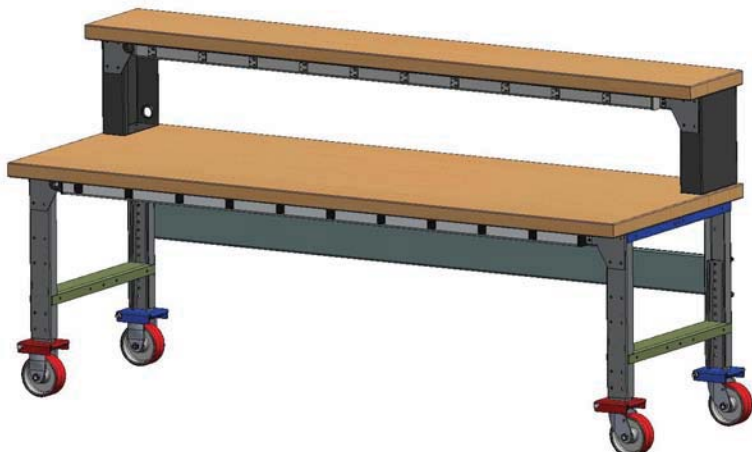

STEP 1

LEVELER KIT OPTION

****SKIP THIS STEP IF YOU HAVE NOT PURCHASED THE LEVELER OPTION****

Thread 1 thin nut onto the leveler.

Place leveler into floor-mount hole at the base of the leg or the base of the insert if its an adjustable height bench. Thread the top nut onto the leveler.

Loosen & tighten nuts to adjust the height of your work bench.

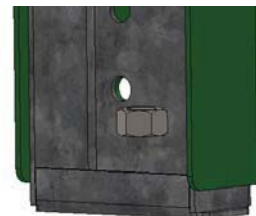

STEP 2

MOBILE CASTER KIT OPTION

****SKIP THIS STEP IF YOU HAVE NOT PURCHASED THE CASTER OPTION****

Attach the single bolt casters to the bottom of the legs or the base of the insert if its an adjustable height bench..

NOTE: TWO TYPES OF CASTERS ARE PROVIDED (SWIVEL AND FIXED) BE SURE TO USE TWO OF THE SAME TYPE AT EACH END OF THE BENCH (TWO SWIVEL CASTERS ON THE RIGHT AND TWO FIXED ON THE LEFT). ALSO BE SURE THE FIXED CASTERS ARE POSITIONED SO THE GREASE ZERK IS ACCESSIBLE FROM THE OUTSIDE OF THE BENCH (SEE FIG. 2). IF ALL SWIVEL CASTERS ARE ORDERED, PLACEMENT WILL NOT BE IMPORTANT.

Insert the top of the caster into the angled lip pocket (this will be the side opposite of the bolt holes), tilt the caster flat against the mounting plate until the bolt is able to be slid behind the caster, locking it in place. Bolt in place using (1) 3/8" x 4-3/4" long hex head bolt and 3/8" nylock nut. Repeat steps for the other caster locations.

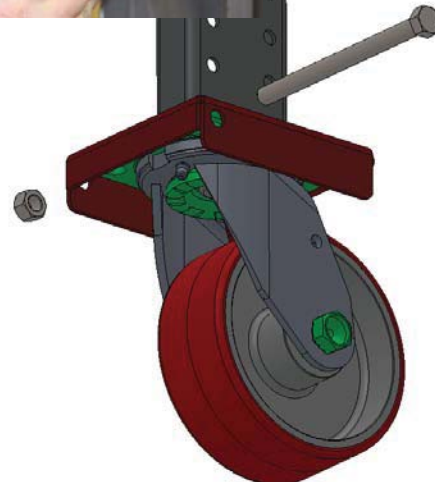

Nylock Nut



3/8" x 4-3/4"
Flange Head Bolt

STEP 3

ADJUSTABLE HEIGHT

****SKIP THIS STEP IF YOU HAVE NOT PURCHASED THE ADJUSTABLE HEIGHT OPTION****

Attach the galvanized adjustable upright inserts to the leg at desired height.

Use (4) 5/16 x 3/4" Bolts with Lock Nuts per insert.



5/16-18 x 3/4"
Hex Head Bolt



Nylock Nut

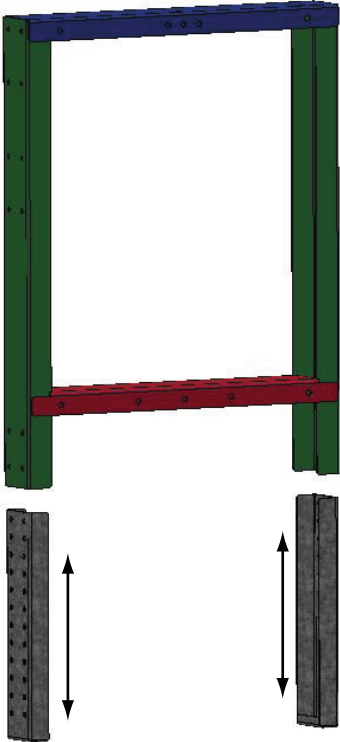

STEP 4

Using (8) 1/4-20 x 3/4" Bolts & Lock Nuts, attach the back brace to each leg assembly. NOTE: Mount the flat side of brace to back side of the legs. Do not fully tighten bolts.



1/4-20 x 3/4"
Hex Head Bolt



Nylock Nut

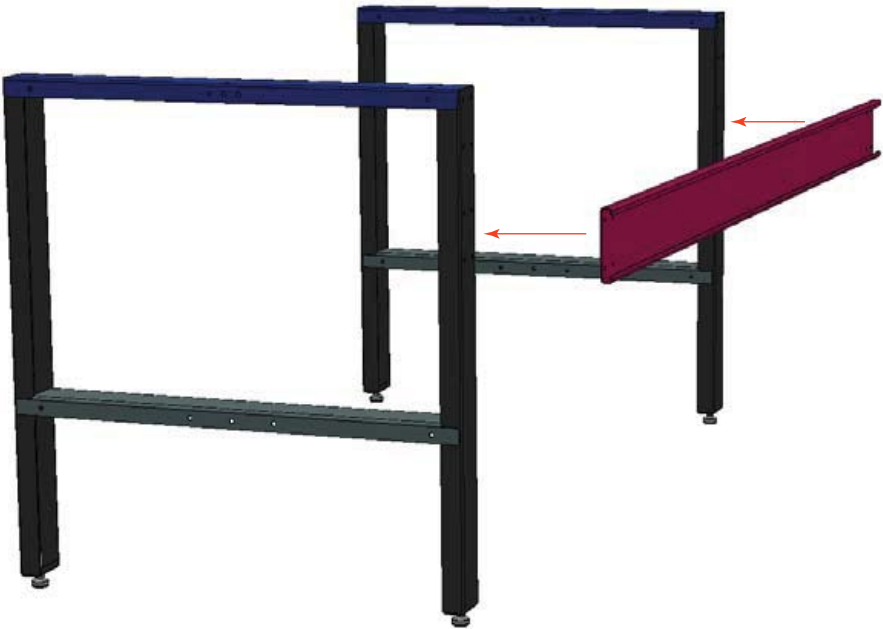

STEP 5

LOWER SHELF OPTION (continue if not purchased)

Slide shelf into place between the two leg assemblies. Two mounting holes on the ends of the shelf will line up with holes on the sides of each lower leg brace.

Use (4) 1/4-20 x 3/4" Bolts & Lock Nuts to attach the shelf to the legs.



1/4-20 x 3/4"
Hex Head Bolt



Nylock Nut

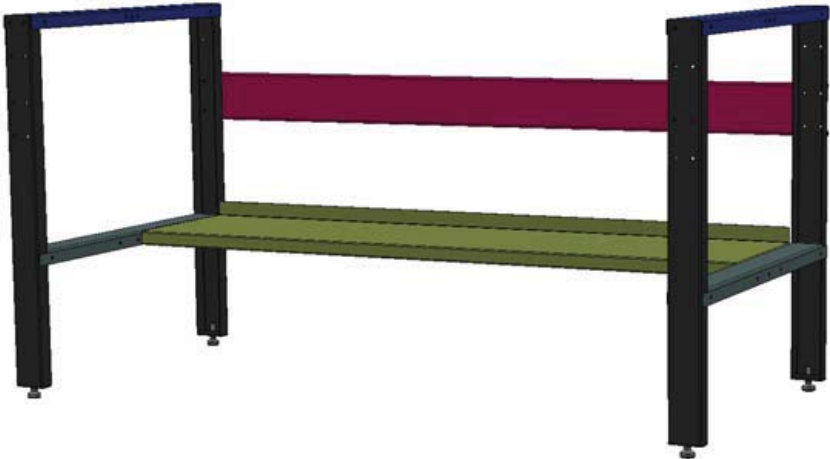

STEP 6

Mount the rear top support brace to the back side of the leg assemblies. Use (8) 1/4-20 x 3/4" bolts & lock nuts.

Once attached square up the bench and fully tighten any previous bolts.



STEP 7

For benches with the lower front power apron it will be easier to mount the apron prior to attaching the support brace to the front of the legs.

There are three clips that need to be attached to the face of the brace. The clips are held on with a simple push in retaining clip. Once all three of the clips are installed, carefully slide the power apron over the clips until centered.

Once the apron is centered on the support brace insert the end retaining clips into the apront and attach to the brace using (4) self tapping screws. Holes will be pre-drilled in the support brace.

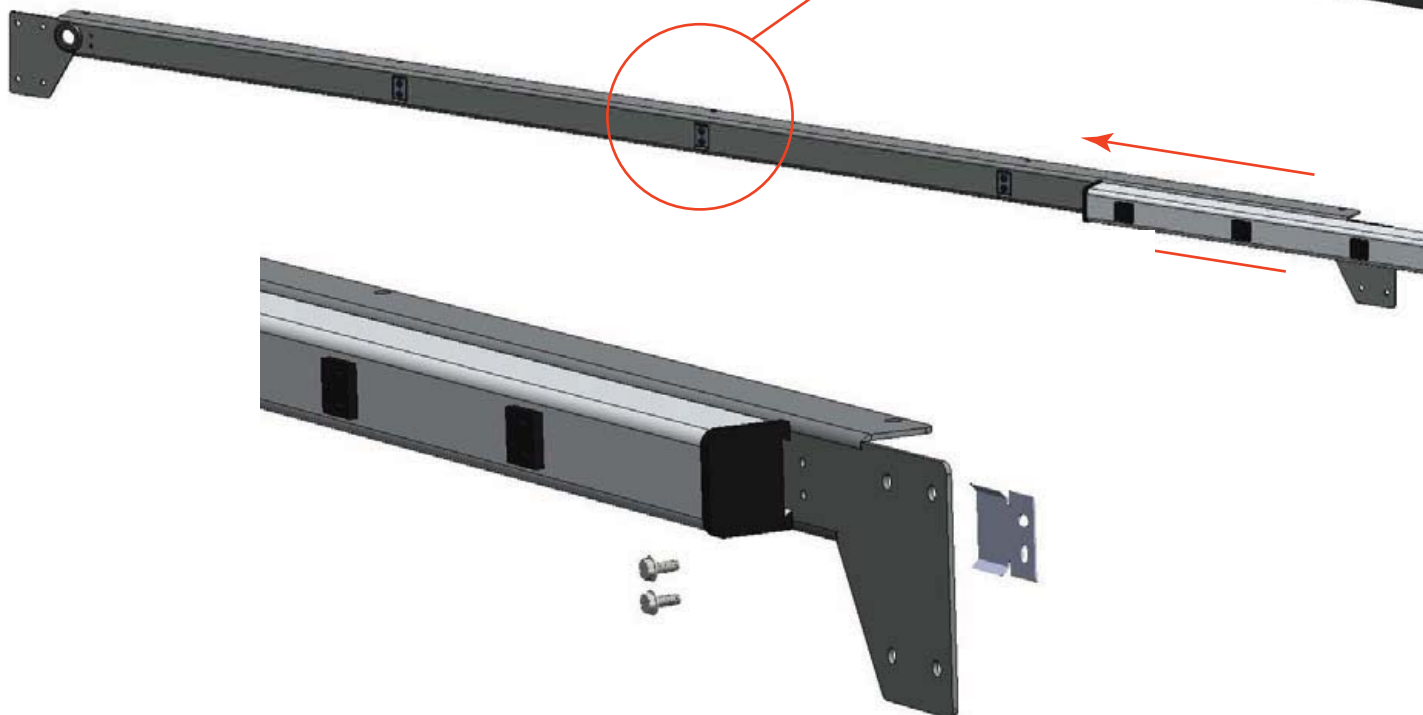

Note: If the bench was ordered with a front upper power apron it can be attached to that front brace at this time as well.

STEP 8

Mount the front top support brace to the front side of the leg assemblies. Use (8) 1/4-20 x 3/4" bolts & lock nuts.

Once attached square up the bench and fully tighten any previous bolts.



1/4-20 x 3/4"
Hex Head Bolt



Nylock Nut

Full Width Support (72"W & Over)



STEP 9

SOLID WOOD OR WOOD CORED STEEL TOP

Place the top right-side up onto the base. Center top both left-to-right and front-to-back. If the bench has a front lower power apron installed on the front brace, be sure the top overhangs the power apron on the front edge.

Attach top to base using #14 Lag screws using the holes in the top of the leg assemblies and the front and rear top supports braces.

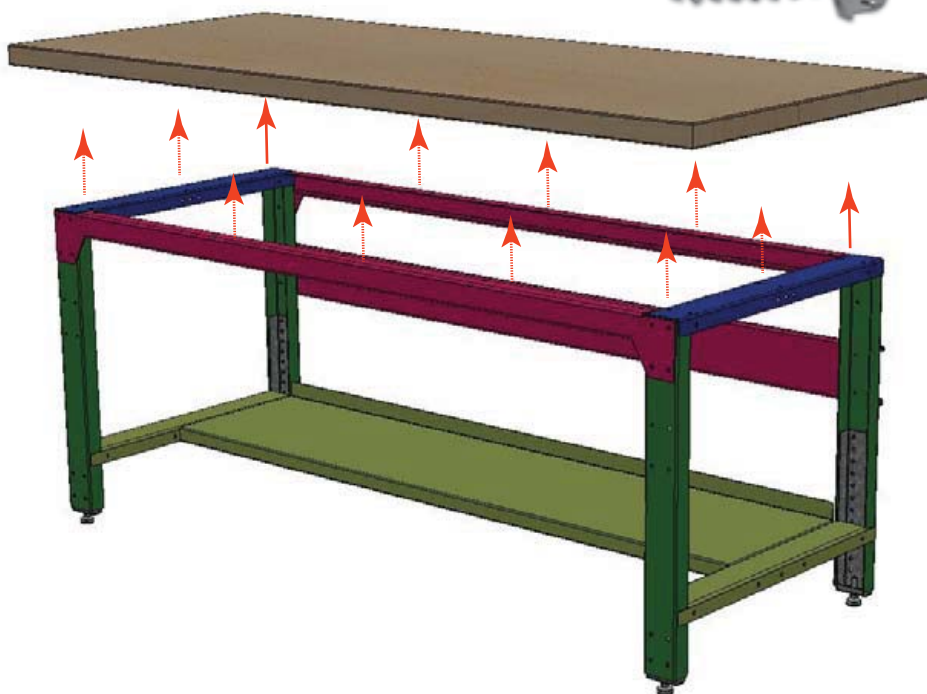

Attach the optional risers to the worksurface using (3) #14 x 1" lag bolts per riser. Once the riser is attached to the top set the shelf on the risers and attach using (3) #14 x 1" lag bolts per riser.



#14 x 1"
Lag Bolt

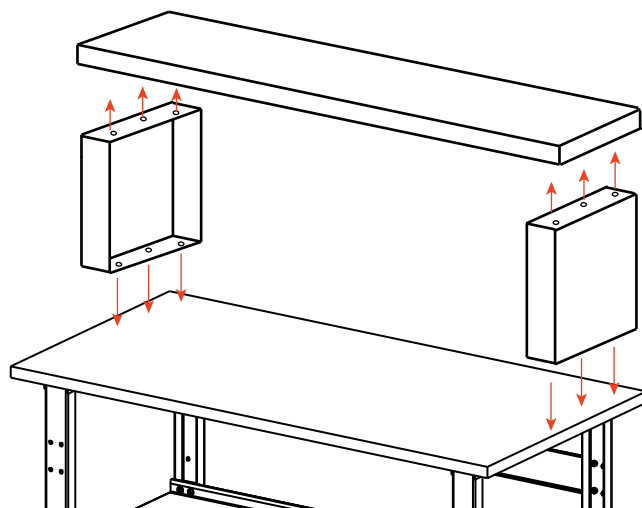

For benches with upper front power aprons only:

The power apron should have been attached during Step 7, if not follow those steps at this time.

Mount the front top support brace to the front side of the riser assemblies. Use (8) 1/4-20 x 3/4" bolts & lock nuts.

Once attached to the riser, lag screw the support brace to the underside of the shelf. using #14 x1" lag screws.



1/4-20 x 3/4"
Hex Head Bolt



Nylock Nut



#14 x 1"
Lag Bolt

