



Greene Manufacturing, Inc.

3985 S. Fletcher Road • Chelsea, MI 48118

(800) 396-4642 • Fax (734) 428-7672

www.greenemfg.com

TOOLS REQUIRED FOR ASSEMBLY

Socket set w/ 1/2" socket, Open end wrench set,
Cordless drill with 5/16" socket bit (Magnetic
recommended), 1/8" Drill bit, & Tape measure.

BEFORE ASSEMBLING THE WORKBENCH

Assembly of this bench will require 2 people.
Read through the assembly instructions to
familiarize yourself with the order in which the
parts are assembled. We suggest that you clear
& vacuum the area where the bench is to be
assembled. It is important that the bench is
assembled in the same sequence as instructed.

HARDWARE & GMI COMPONENTS

All assembly hardware is provided.

CBL-1500.M



STEP 1

****Units are difficult to move once assembled.
Begin assembly in the bench's final location****

Arrange cabinets back-to-back and side-to-side.
If your floor isn't level, they may not sit at the same
height. You can adjust the cabinets' height by turning
the leveler inserts in the bottom of the cabinets.
(It is much easier to adjust before the cabinets
are bolted together)

Once adjusted, Open the doors of the cabinets
and attach using (8) 5/16 x 3/4" Bolts with Lock
Nuts. Requires 2 people.



Nylock Nut



5/16- x 3/4"
Hex Head Bolt

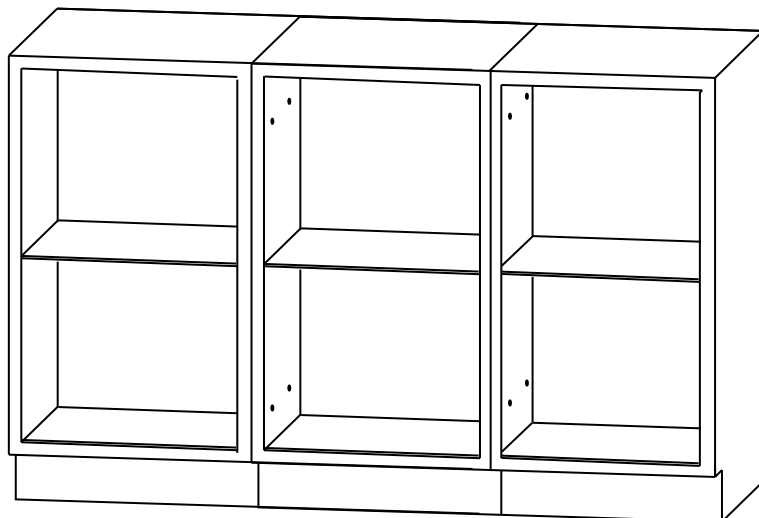

STEP 2

Position 4 strips of the brown fiberboard material on top
of the cabinet. The strips will create a small air gap between the
cabinet and worksurface to allow air flow around the top.

Carefully flip the top right side up & place on the cabinets as shown
to the right.

Adjust top so that it sits centered on the cabinets.

Mounting holes should be pre-drilled into the wood top, 1" deep.
Attach using (4) #10 x 1" Lag screws per cabinet.

Because the wood top is a natural product it can expand and contract
due to being exposed to moisture or environmental changes in
humidity. When tightening the lag bolts it is recommended to first
tighten and then back the bolt out 1/4 turn. This will allow the top to
expand and contract to help minimize any cracking or warping that
may occur.

Failure to properly mount the top will void
warranty.



#10 x 1"
Lag Bolt

