

CBL-5464-8.M

TOOLS REQUIRED FOR ASSEMBLY

Socket set w/ 1/2" socket, Open end wrench set, Cordless drill with 5/16" socket bit (Magnetic recommended), 1/8" Drill bit, & Tape measure.

BEFORE ASSEMBLING THE WORKBENCH

Assembly of this bench will require 2 people. Read through the assembly instructions to familiarize yourself with the order in which the parts are assembled. We suggest that you clear & vacuum the area where the bench is to be assembled. It is important that the bench is assembled in the same sequence as instructed.

HARDWARE & GMI COMPONENTS

All assembly hardware is provided.

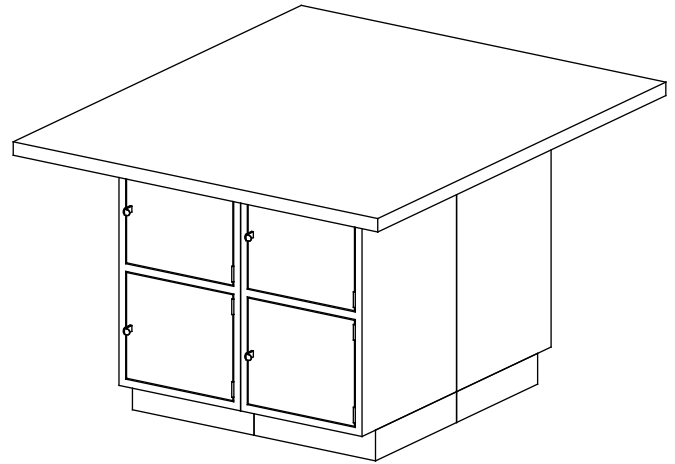

STEP 1

Units are difficult to move once assembled. Begin assembly in the bench's final location

CAUTION: If cabinets are numbered. Be sure to keep the cabinets in sequential order.

Each station contains 4 individual locker cabinets. First connect the cabinets side-to-side using (8) lock nuts and bolts (4 bolts/nuts to connect a pair of cabinets). Then push them back-to-back and connect using (8) lock nuts and bolts.

HARDWARE: 5/16" x 3/4" Bolts & Lock Nuts.

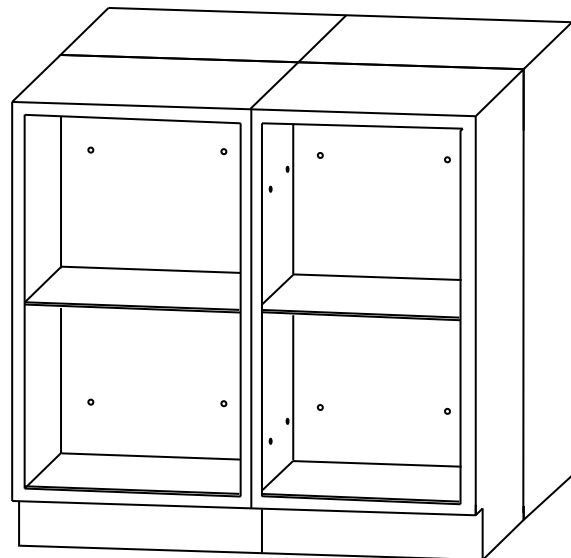

5/16 x 3/4"
Hex Head Bolt



Nylock Nut

STEP 2

Locate a flat & clean surface to work on. You may want to lay down a blanket to avoid scratching the tops.

Connect the two halves of your Maple top using (5) Draw Bolts.

Insert the Draw Bolts in the routed slots as shown in Figure 1.

Make sure the 2 tops are even on the finished top side before you fully tighten the bolts.

Fully tighten all draw bolts.

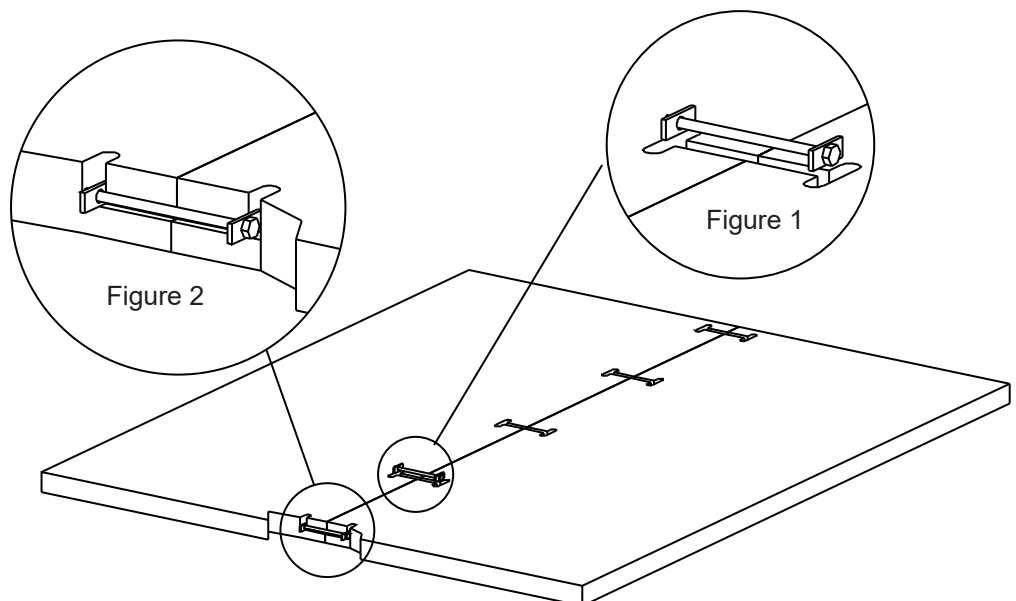

STEP 3

Position 4 strips of the brown fiberboard material on top of the cabinet as shown. The strips will create a small air gap between the cabinet and worksurface to allow air flow around the top.

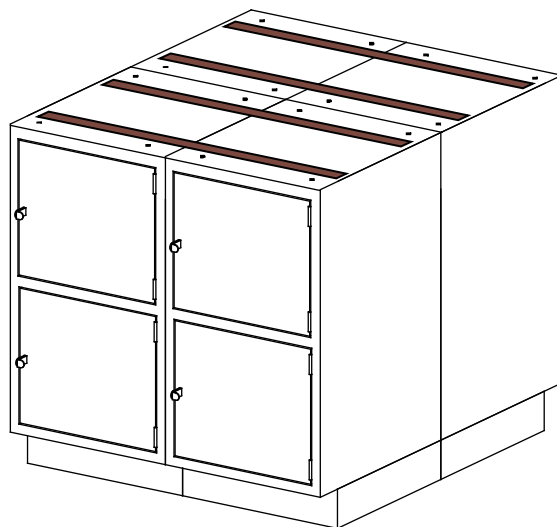

STEP 4

Carefully flip the top right side up & place on the cabinets as shown to the right.

Adjust top so that it sits centered on the cabinets.

Mounting holes should be pre-drilled into the wood top, 1" deep.

Attach using (4) #10 x 1" Lag screws per cabinet.

Because the wood top is a natural product it can expand and contract due to being exposed to moisture or environmental changes in humidity. When tightening the lag bolts it is recommended to first tighten and then back the bolt out 1/4 turn. This will allow the top to expand and contract to help minimize any cracking or warping that may occur.

Failure to properly mount the top will void warranty.

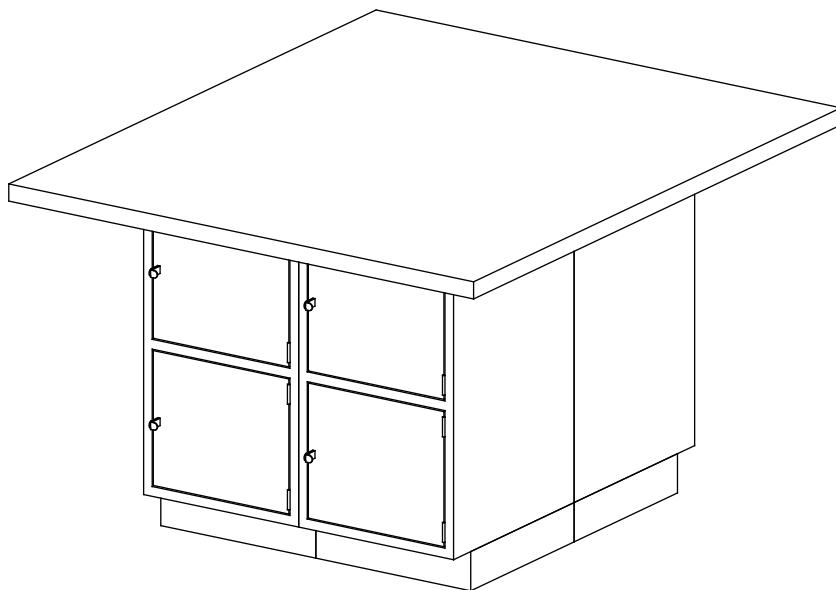

#10 x 1"
Lag Bolt