

PCL Workstation

TOOLS REQUIRED FOR ASSEMBLY

Electric Hand Drill, Phillips Head Bit, 3/8" Magnetic Hex Driver Bit, Socket Set and Ratchet.

BEFORE ASSEMBLING THE WORKBENCH

Read through the assembly instructions to familiarize yourself with the order in which the parts are assembled.

We suggest that you clear & vacuum the area where the bench is to be assembled.

It is important that the bench is assembled in the same sequence as instructed.

HARDWARE

All assembly hardware is provided.



STEP 1

Flip the desks top upside down on a blanket or other clean surface to avoid scratching the top.

Attach the legs to the top using the (4) 1/4-20 x 2-1/2" hex head bolts by threading into the pre-installed nuts in the top. DO NOT FULLY TIGHTEN THE BOLTS TILL MODESTY PANEL AND BRACE ARE ATTACHED.



1/4-20 x 2-1/2"
Hex Head Bolt



STEP 2

Once legs are attached position the counter top support brace between the legs towards the front edge of the desk. Attach the brace to the legs using (4) 1/4-20 x 3/4" flange head bolts by threading into the pre-installed nuts in the leg. See arrows in pink.



1/4-20 x 3/4"
Flange Head Bolt



STEP 3

Once the support brace is attached to the legs, secure the brace to the top using (3) 10 x 5/8" Spax screws. Screw through the holes in the brace and into the bottom of the worksurface.



#10 x 5/8"
SPAX Wood Screw



STEP 4

Skip this step if no wire management tray was ordered.

Set the wire tray in place on the top, do not attach the tray yet.



STEP 5

Insert the modesty panel between the desks legs. The tray will tilt into the U shape channel of the wire tray (If ordered).

Attach modesty panel to the leg using (4) 1/4-20 x 3/4" flange head bolts by threading into the pre-installed nuts in the leg. See arrows in pink.



1/4-20 x 3/4"
Flange Head Bolt

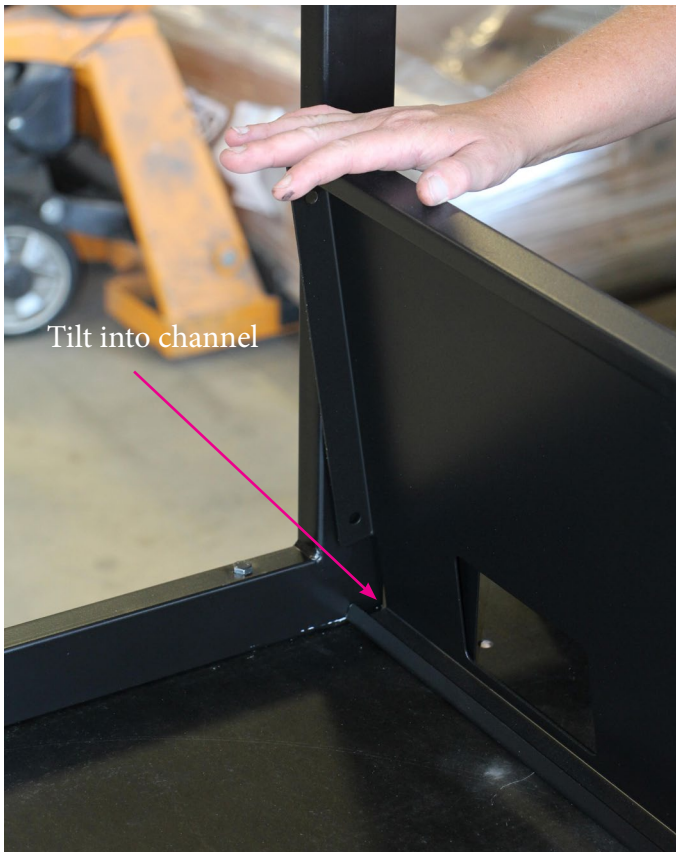

STEP 6

Once the modesty panel is secure, finish attaching the wire tray (if ordered). Use 5/8" spax head screws and mount to the underside of the top through the mounting holes at the back edge of the desk.



#10 x 5/8"
SPAX Wood Screw



STEP 7

Attach the end caps to the wire tray (if ordered) using (4) 10-32 x 3/4" screws into the pre-installed nut inserts of the end of the wire tray. Attach to the top with (2) 1/4-20 X 3/4" flange head bolts into the pre-installed nuts in the top. Insert grommets into both ends.



10-32 x 3/4"
Screws



1/4-20 x 3/4"
Flange Head Bolt

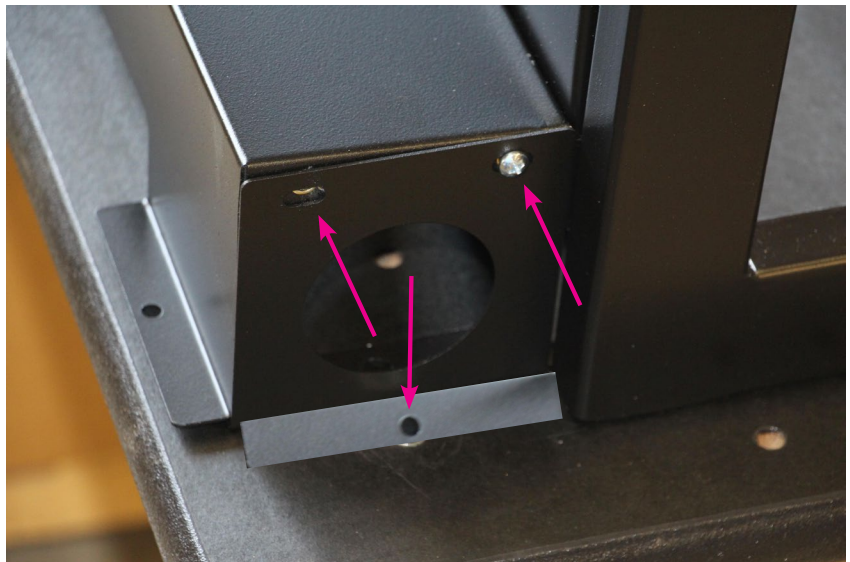

STEP 8

TIGHTEN THE LEG ASSEMBLY BOLTS TO THE TOP FROM STEP 1. Flip desk over on its legs, right side up, this may require assistance. Insert grommets into the top of the work surface.

Your workstation is now complete.